

LATAH



4 BEDS

3 CAR GARAGE

3.5 BATHS

2926 SQFT

ALTURAS
HOMES

This very special Latah floor plan, located at Pinnacle in the SO|ME District, features a secondary bedroom with en suite bathroom upstairs along with a primary bedroom on main level. A wonderful option to offer privacy for house guests. With the open plan of the main living area, the kitchen and dining area flow seamlessly to the spacious patio, opening up even more space for dining and entertaining guests. The bonus room on the second floor offers a flexible additional living space.



COMMUNITY FEATURES

Lifestyle Community
Charter School
Meridian Public Library
Next to Discovery Park

Amphitheater
Multiple Swimming Pools
Interconnected Walking Paths
Local Towncenter



alturashomes.com

LATAH

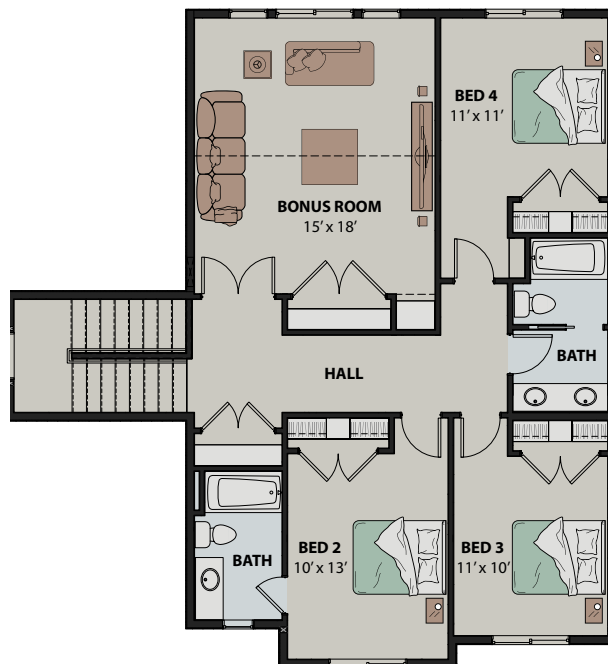

Interested in a new home?

Kat Gray
208.200.5005
katgray@alturas.com